

Unit:mm

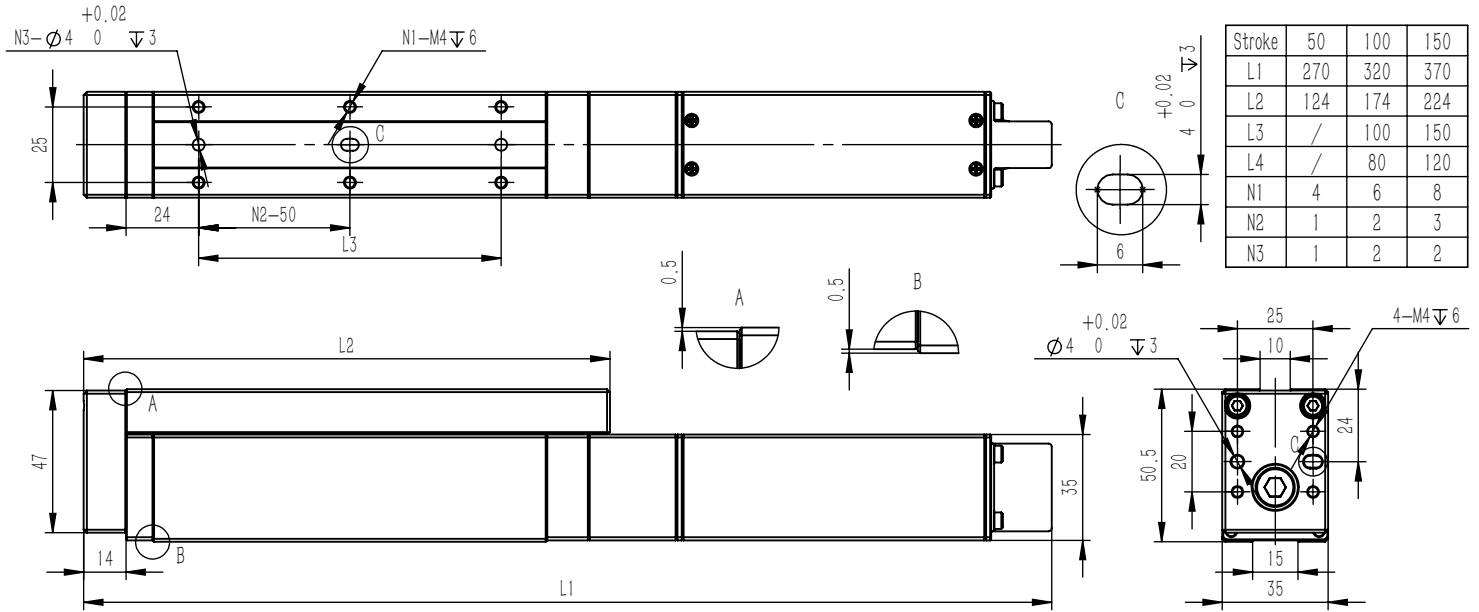

Stroke	50	100	150
L1	270	320	370
L2	124	174	224
L3	/	100	150
L4	/	80	120
N1	4	6	8
N2	1	2	3
N3	1	2	2

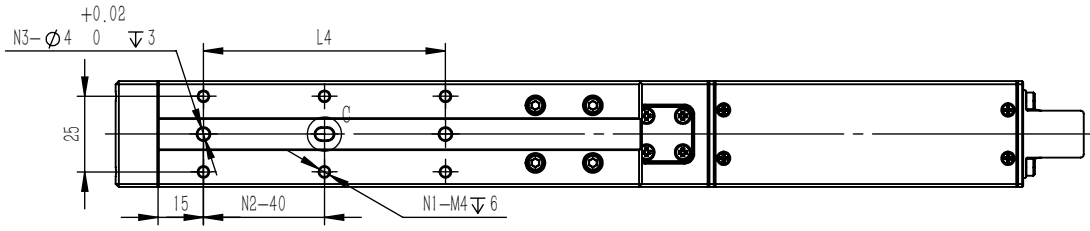

Note.

1. When fixing the main body, please make use of all the screw holes on same mounting surface,
2. Don't exceed the depth of the threaded hole when tightening the bolt.